

STRIP MODULE 1W or 3W

PRODUCT OVERVIEW

Strip Module is a single strip High Power LED Fixture designed to create uniform illumination or produce a dynamic light effect. It is available in various length 300mm, 600mm, 900mm and 1200mm. The fixture is available as a wide angle beam or as a powerful linear wall washing system with highly efficient optical components. The Strip Module system can be configured for interior or even IP66 exterior applications.



APPLICATION

- Architectural Lighting
- Floodlighting
- Dynamic Light Effect
- Commercial Lighting

FEATURE and OPTION

- Cree / SSC / Orsam Opto 1W and 3W versions also available
- IP42 / 67
- Any color combination
- Deep Saturation color
- Long life >50,000hrs
- Energy efficient.
- Aluminium Robust construction
- Lens is optional (6, 15, 25 degree or wall wash)
- Thermal protect is optional
- Fully DMX dimmable
- Adjustable mounting brackets

IP67

Any
Color

Lens
Optional

1W or 3W

Al core
PCB

RJ45
Connector

Long Life

3 Years
Warrant

STRIP MODULE 1W or 3W

TECHNICAL SPECIFICATION

Light source	SSC / Orsam Opto 1W, 3W LEDs (K2 and Cree is available on request)
Beam Angle	6, 15, 25 or 25x8 degree
Housing	Aluminum extrusion (T6063)
Color	Silver (Brighten Anodize Finish)
Lenses	Clear Optical grade acrylic
Connectors	RJ45 socket with 3M UL2464 cable
Input Voltage	48VDC
Max Driver current	350mA (1W) or 700mA (3W) per Channel
Power consumption	at 350mA Max 12W per 300mm
Power consumption	at 700mA Max 30W per 300mm
LED Life	100,000 hrs(Typical Lumen maintenance 70% at 50,000 hours @ 25°C ambient temperature)
Operating Temperature	-10°C to 40°C
Compatible Driver	Modulation Driver (refer to 3ch DMX interfaced dimmable Driver Specification)

Unit is equipped with thermal sensor (optional and on request) which will protect the LEDs from high ambient operating temperature. See Modulation Driver data for full details of mains power requirements and DMX operation.

Products represented here are IEC825 Class 2 for eye safety. Do not stare into the L.E.D. light beam at close range. Fixtures should only be connected to approve LED drivers.

SELECTION GUIDE

For SSC 1W only

	LED color available	LED Color Code	Color Temp or dominate Wavelength	Typical Luminous Flux (lm)
	Warm White	WW	3000 / 3300K	40
	White	W	5500K / 6000K / 6500K	60
	Blue	B	470nm	16
	Royal Blue	RB	455nm	220mW
	Green	G	530nm	53
	Cyan	C	505nm	45
	Red	R	625nm	44
	Amber	A	590nm	42
	RGB	RGB	N/A	N/A

Remark: The above specification is base on the LED component specification.

Selection Guide

Part No.

S36-RGB-OV-L1-900

Module length
300 – 305mm
600 – 605mm
900 – 905mm
1200 – 1205mm

L1- 1W 350mA
L3- 3W 700mA

Blank - Interior system
S36 – Strip, 36 LEDs
IP S36 – Strip, 36 LEDs, IP67

Color Code
RGB – R, G, B
WW – Warm White
W - White

Beam Angle
06 – 6 degree
15 – 15 degree
25 – 25 degree
OV – 25 x 8 degree (wall wash)

TECHNICAL DRAWING – DIMENSION

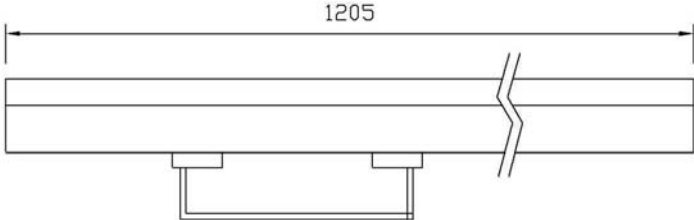
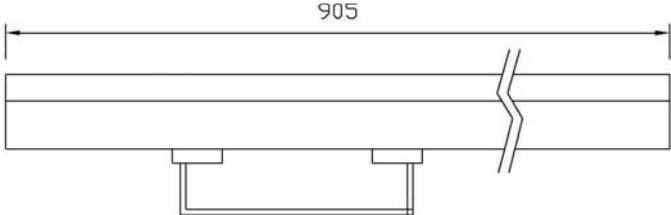
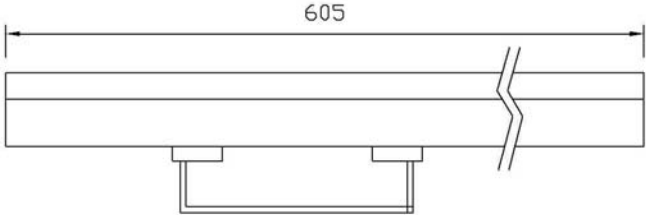
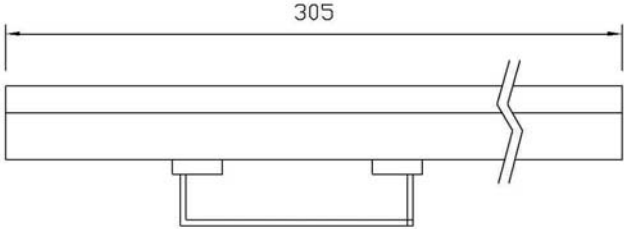
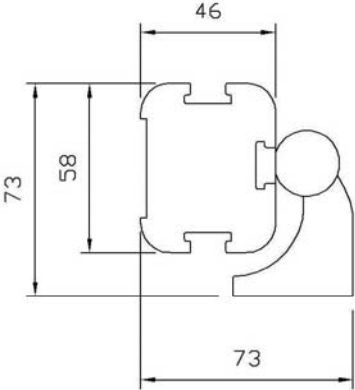

TECHNICAL DRAWING- CONNECTION

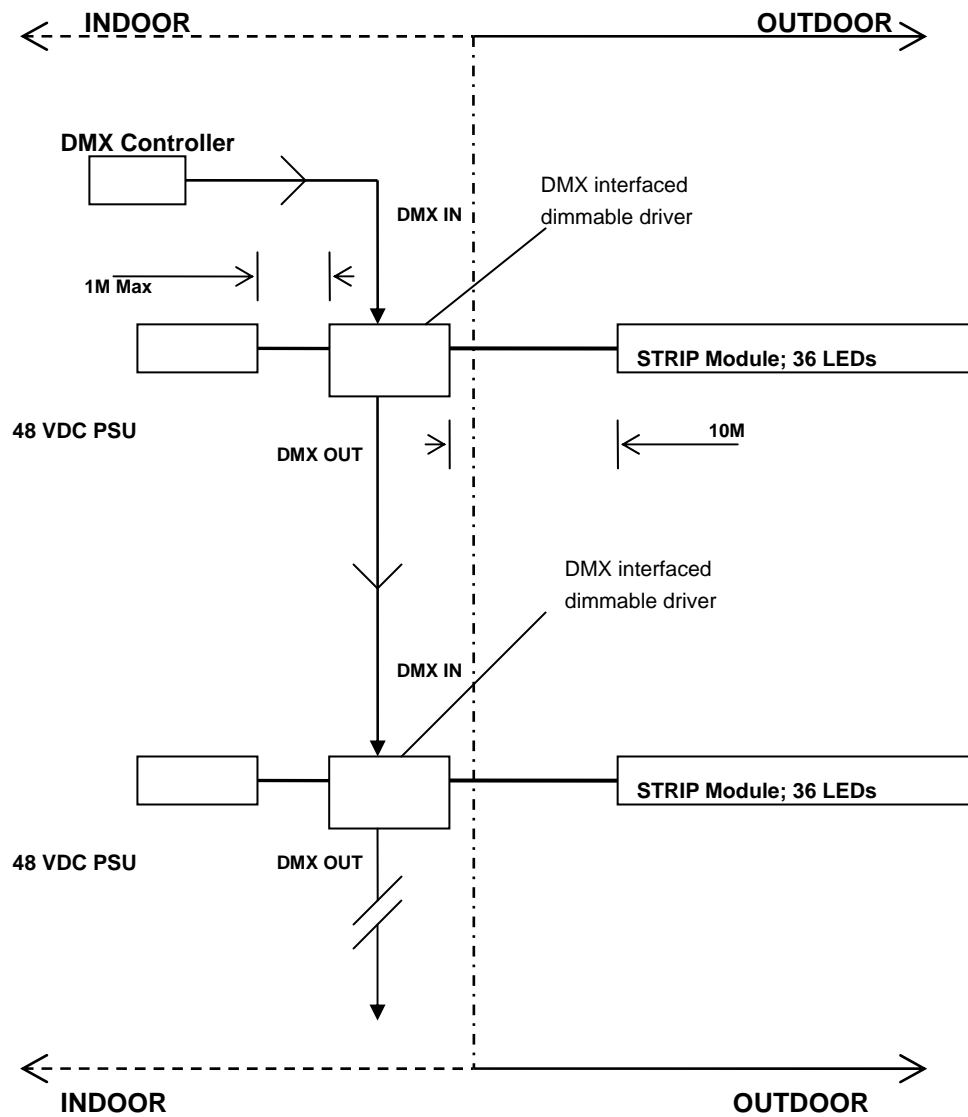

Notes:

- 1) Each "DMX interfaced dimmable driver" need 50W, 48VDC PSU to drive.
- 2) The length limitation of DC power cable between PSU to Dimmable Driver 1M max.
- 3) The length limitation of the cable between RGB driver and module is 10M Max.
- 4) The max number of Dimmable Driver are 30 units within a DMX network